

vinyl APPLICATION GUIDE

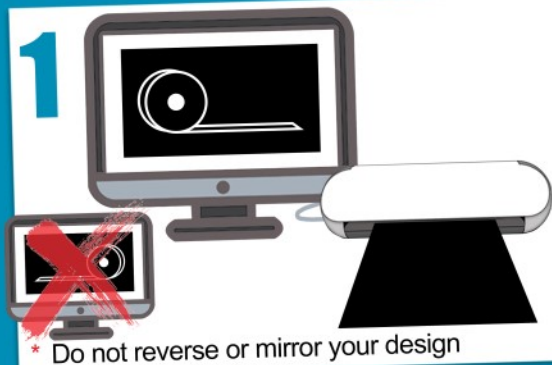

1 Do not reverse or mirror your design

Cut your design using a plotter or contour cutter. Only cut through the top layer of material and not the paper release liner.

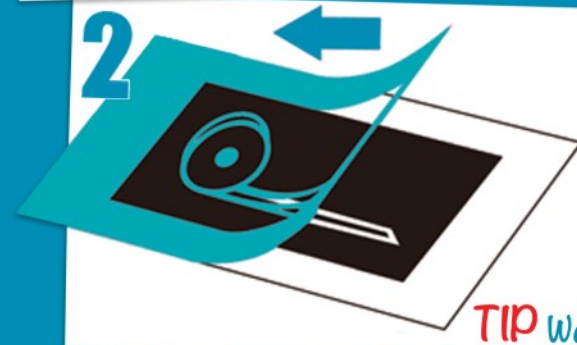

2 **TIP** Weeding tweezers make this process quick and easy.

Once cut weed away the excess material until the finished design is left on the white release paper

3 Apply application tape over the decal. Use an application squeegee to ensure the tape is firmly pressed down to the finished side of the graphic.

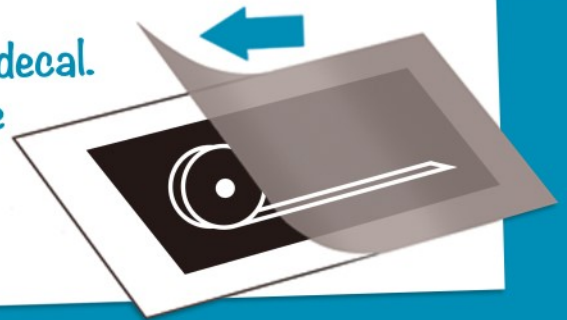

4 You should now have the graphic between both the paper release liner and the application tape.

Flip your design over and carefully peel away the paper release liner, exposing the adhesive.

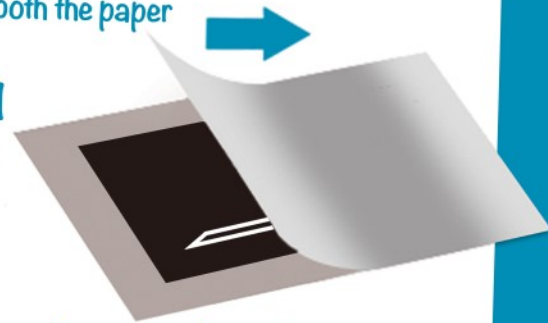

NOTE DO NOT try to lift the decal off the release liner using the application tape

5 Ensuring the surface is clean and free from dust use the app tape to carefully place the design. Apply the decal and peel away the application tape.

TIP Mix some water with a small amount of mild detergent into a plant spray bottle. Liberally spray onto the chosen surface and place the vinyl. Using the application squeegee, start from the centre and push the liquid outwards. Wipe dry with a clean cloth. This will ensure bubble free application.

After a few hours any remaining moisture under the decal will dry and the adhesive will be at full strength.

