

**1**



Cut the image using a plotter or contour cutter. Only cut the top layer of material and not the clear transfer liner.

**NOTE** Do not reverse or mirror the image in your cutting software.

**2a**

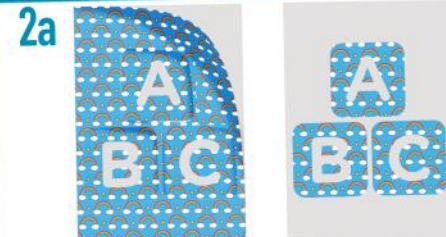

Weed away any excess material until the finished image is left on the clear release liner.

This is called 'weeding'

**TIP** Weeding tweezers make this process quick and easy.

**2b**

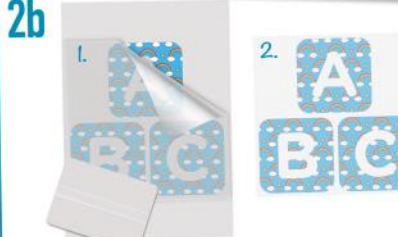

**1.** Once weeded use our HTV Transfer Film to cover the image. Push out any bubbles and creases using an application squeegee.

**2.** Use the HTV Transfer Film to lift the image from the clear carrier.

**NOTE** Your design should now be on the back of the HTV Transfer Film

**3** Pre-heat the T-shirt for 10 seconds to remove any moisture.

Place the image or design face up onto the garment. Once positioned cover the design using a silicone sheet for protection.

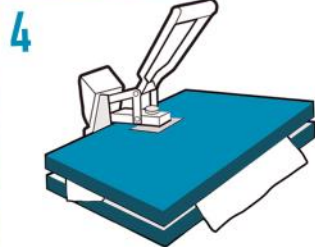
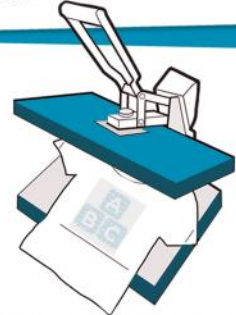

Using medium pressure press for 15 seconds at 160°C

**IF USING A DOMESTIC IRON**

Ensure the garment is on a flat surface and is crease free. Firmly & slowly iron over the protective sheet in both vertical and horizontal lines for 15 seconds.



Remove the silicone sheet and peel away the HTV Transfer Film whilst the material is still warm.

**Warm Peel**

**NOTE** Leave for 24 hours before washing.



Application & Wash Care Symbols

[www.gmcrafts.co.uk](http://www.gmcrafts.co.uk)

